

# Yateley School Parents' Bulletin

**Issue:** 08

**Date:** 25<sup>th</sup> October 2019



[www.yateleyschool.net](http://www.yateleyschool.net)



@yateleyschool



@yateleyschool



[admin@yateley.hants.sch.uk](mailto:admin@yateley.hants.sch.uk)



School Lane, Yateley  
GU46 6NW



(01252) 879222

**Learning together – Empowered for life.**

## Dear Parents



Clearly, one of the major highlights of the past week has been the amazing Dance Show and House Dance. The quality of the production, as we've come to expect, was absolutely first class and the audience was mesmerised by the extraordinary talent and determination on display. The students have been working for months on their pieces and their dedication and commitment to excellence absolutely paid off. It was notable how wide the participation levels were, with a vast number of students from across the different year groups and many more boys performing. The variety was impressive too, with ballroom and Latin numbers, through to ballet, contemporary pieces and even street and hip-hop. It is also, of course, a competitive event and the Houses

had all worked phenomenally hard to produce interesting, highly skilled and thought provoking work. The subject matter ranged from the bleak to the frankly terrifying, but the story telling was exceptional. It was a well fought and tight battle, so huge congratulations to the eventual victors – Nightingale House.



## Parent Forum

Shortly after the half term holiday, I would like to open a



termly parent forum, subject to interest. The likely plan would be to offer an open discussion forum in the early evening (6-7pm) and with it a chance to ask questions, hear some detail about the school's planning and share views – both positive and any concerns. I anticipate giving each meeting a theme and inviting the appropriate member of the senior leadership team to join me for the session. If you think this may be of interest, please watch this space for future dates.



Hampshire  
County Council



# Yateley School Parents' Bulletin

Do please note (as per the school comms) there is an election for parent governor and I'm delighted that there are so many candidates. Your child should have arrived home on Thursday with the voting papers – one parent one vote. Please make sure votes have been cast and placed in the ballot box in reception by 15 November 2019

Also, please note that if you are a parent of a child in year 6, or know someone who is, that applications for secondary school places must be made by the end of this month 31<sup>st</sup> October 2019.



What's a rip rap? An equimolar? Synaptogenesis? The Gini coefficient? Perhaps you're not sure... but now we've launched PiXL Unlock across the whole-school launch students can develop their subject vocabulary and become experts in all subjects!

PiXL Unlock provides a mobile and desktop app that allows KS3, KS4 and KS5 students to develop their language and get instant feedback on whether they've understood a word and can use it correctly! The take-up from students has been sensational, we're currently second in the country for usage, having answered over 5,500 questions this week alone!



## Secondary schools + Sixth form centres - weekly challenge:

Rank	School name	Sticklady score
1	Easthampstead Park Community School	94035
2	Yateley School	55554
3	Huish Episcopi Academy	43732

Once again our students are showing themselves to be sensational in their desire to improve! Keep it going Yateley!

"This house believes that the world would be a better place with women in charge"

"This house believes that Teen defendants should be judged by teen juries"

We are delighted to be introducing "Up for Debate" which is now entering its fifth year with over 200 schools participating. Up For Debate is a debating competition that builds a culture of whole-school oracy for pupils and teachers. The program is a national competition for Year 9s involving regional



Hampshire  
County Council



# Yateley School Parents' Bulletin

championships across the country, a residential masterclass programme and a prestigious national finals day in July, showcasing achievement of all pupils involved in the programme at the Cambridge debating chambers. Students in Year 9 will soon hear more about the opportunity and have the opportunity to get started...



**Student Star of the week** this week is Taylor Cox in 7PN. The poor lad has spent the last two weeks based in the Wellbeing Centre to get on with his work whilst unable to walk and bear weight on his broken leg. His spirit and good humour has been first class throughout, not missing any school or complaining. He arrives before 8.30am every morning, cheerful, polite and just gets on with it. We prize resilience and endeavour and Taylor has shown this in abundance.

It remains for me to wish all those associated with Yateley School a happy and restful half term holiday – a time to catch up with work for some, but a well-deserved rest for all. Monday 4<sup>th</sup> November is an INSET day, with pupils returning on Tuesday 5<sup>th</sup> November.

Yours sincerely

Paul German

**Headteacher**

## SPORTS RESULTS

### FOOTBALL

Year 10 won v Courtmoor      2 - 0      Goal scorer: Elder x2

### NETBALL

Year 8 won v All Hallows      15 - 13      POM: B. Nwachukwu & M. Jacobs



**HAPPY HALLOWEEN FROM GRAPHICS**



Hampshire  
County Council



# Yateley School Parents' Bulletin

## Accessing Show My Homework



**RM Unify**  
Your Launch Pad to the Cloud

Show My Homework (SMHW) has undergone rebranding to Satchel: One, forming a suite of applications designed specifically for the classroom learning and teaching environment.

Until now, it has been a requirement to have separate login credentials for some of the individual IT systems deployed here at Yateley School, including SMHW. With the introduction of RM Unify, we have the ability to harmonise non-associated systems, such as SMHW, into a single sign on (SSO) user experience, both for teacher and student alike.

During the coming October half term, we will therefore switch over to RM Unify for users wanting to access SMHW, this will include Teachers and Students but not Parents. Those Parents who have access to SMHW will continue to logon as they do today and therefore not feel any impact by this change.

Once activation is complete, Teachers and Students will be required to pass through RM Unify before being able to access their SMHW account. Other than the initial change to how you log on, all other aspects and functionality of SMHW remains the same.

### How it looks today

Users arrive at the SMHW landing page [here](#) and are required to logon their specific SMHW username and password, which is completely independent of other existing Yateley School systems.

using

Figure 1

### Future Expectation

Once we have activated the link between SMHW and RM Unify, it will still be possible to access the standard SMHW landing page [here](#) as before, but it will also be possible to access SMHW via a dedicated tile on the launchpad from within RM Unify [here](#).

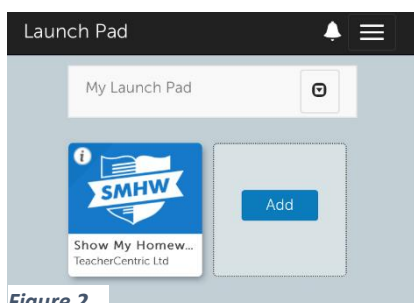

Figure 2

Regardless of which method is used, the password will now be the same as the password used to logon to school computers, which in turn is the same password for accessing email, and therefore it will no longer be necessary to remember a separate convoluted password specifically for SMHW.

If you choose to access SMHW from its own login page as per the web link below, be sure to scroll down to find a list of alternative ways to log in, selecting the option **Sign in with RM Unify**

<https://www.satchelone.com/login?subdomain=yateley&userType=student>



# Yateley School Parents' Bulletin

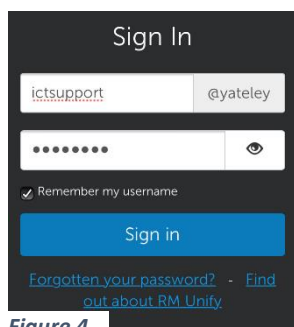

Figure 4

This will redirect the user to the RM Unify SSO sign in page, where the user must enter either their full school email address or their school network logon username, plus the associated password.

Figure 3

If the user already logged on to RM Unify themselves, they can simply press the **Show My Homework** tile as detailed in **Figure 2**, providing direct access to SMHW website without the additional need

## AMAZING CURRIES



Mrs Quick has been very impressed with the year 9 effort made in presenting food to a high standard, in particular the work of Scarlett Tonks and Nerys Illott. Well done



# Yateley School Parents' Bulletin

House Points, Behaviour & Conduct: Weekly Update 05.09.19 to 18.10.19

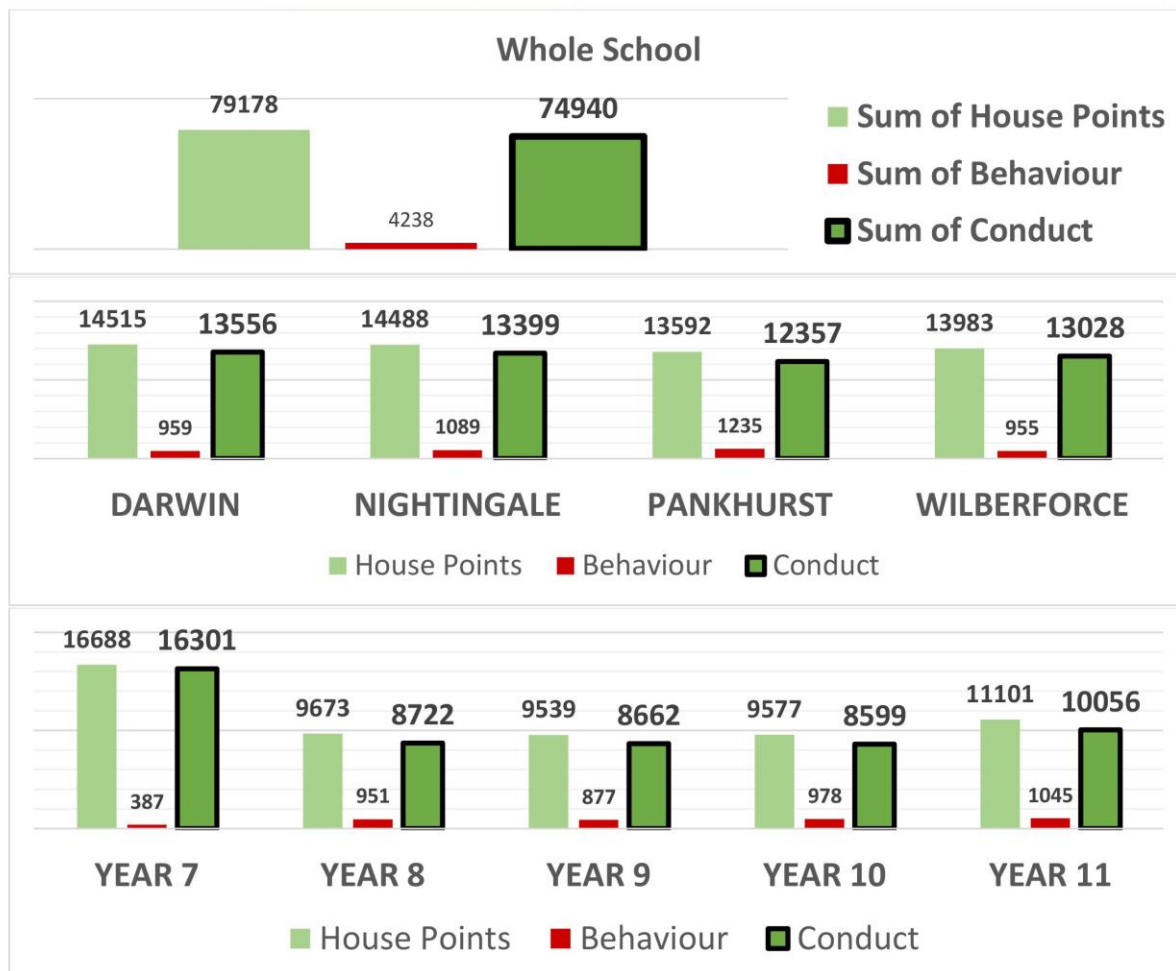

Please note that all Year 11 students were given 100 House Points at the start of Sep 2019 due to the new Prom Points initiative for Year 11 this year, and therefore why they have more than any other year group.

## Tutor Groups With The Highest Conduct Points (House Points – Behaviour)

Year 7	Year 8	Year 9	Year 10	Year 11
7DN	8PN	9NN	10PS	11WN

## Tutor Groups With The Highest Average Conduct Points (House Points – Behaviour)

Year 7	Year 8	Year 9	Year 10	Year 11
7DN	8PN	9NN	10PS	11WN

## House With The Highest Average Conduct Points (House Points – Behaviour)

Year 7	Year 8	Year 9	Year 10	Year 11	OVERALL
Darwin	Pankhurst	Nightingale	Pankhurst	Wilberforce	Wilberforce

Whole School Attendance: 96.70%

## Tutor Groups With The Highest Attendance

Year 7	Year 8	Year 9	Year 10	Year 11
7DN	8DS	9NS	10NN	11NN



Hampshire  
County Council



# Yateley School Parents' Bulletin



## Chess Puzzle



Last week's solution requires you to notice that the rook on rank 8 is not protecting the rook on rank 2. It is required to prevent an easy mate of the trapped king. This makes the exchange on b2 more favourable to white that it first appears.



This week: find the best move for white.



Bring your solution to Chess Club on Thursdays at lunchtime in C21.

## Maths Corner 7

### Greedy Girls!

Anna has just got her pocket money. She goes straight to the Sweet Shop and buys 3 Curly Wurlies and 2 tubes of Smarties. They cost her £1.49. Beth has just won £5 in a raffle. She went to the same Sweet Shop and bought 6 Curly Wurlies and 3 tubes of Smarties. She got £2.39 change.

How much is a Curly Wurly?  
How much is a tube of Smarties?



1 house point to all parents/student who presents the correct answer to their maths teacher before next weeks Maths Corner is published.

**Answer to Maths Corner 6 – Jack and Jill!**

Jack = £88, Jill = £66



Hampshire  
County Council



# Yateley School Parents' Bulletin

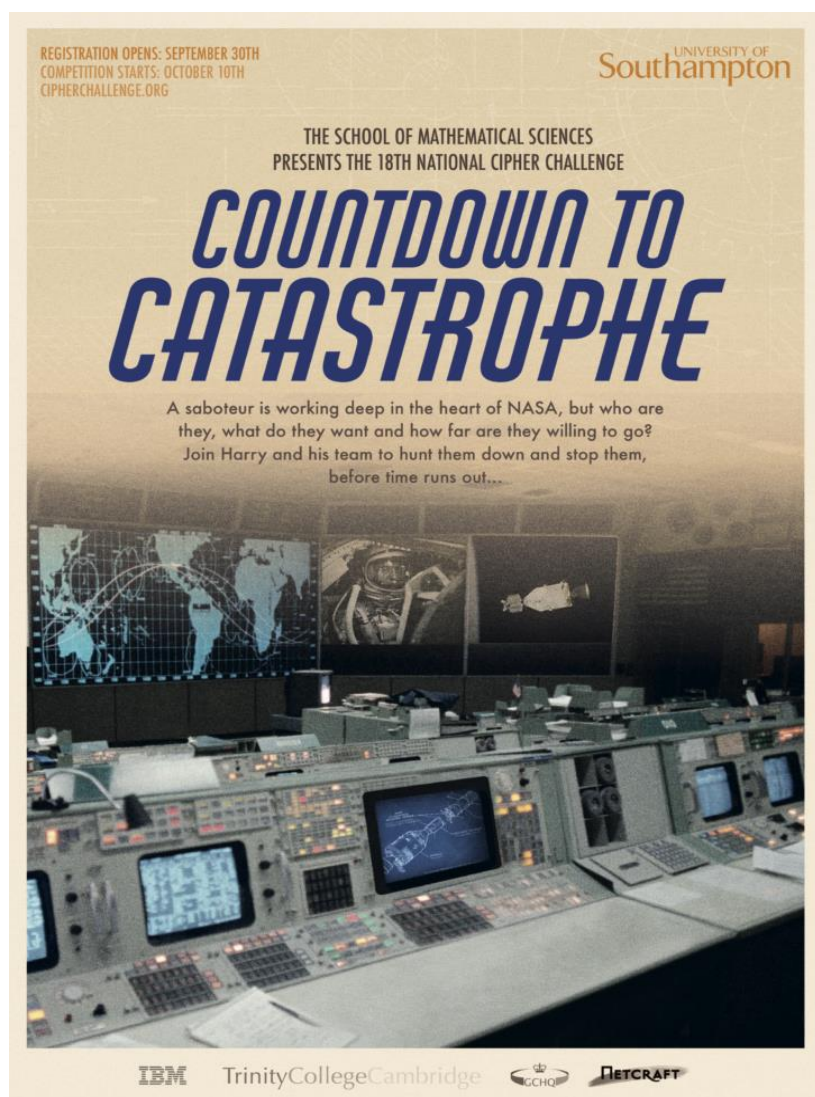

## CALL ME HARRY

I am a codebreaker. I am an engineer. I work at NASA.

Since 1958 we worked to get Alan Shepard into orbit, Jim Lovell behind the moon and Neil Armstrong to step on it. But we were not perfect. We came close to failure on many missions. Can you unlock our secrets? How close were we to losing our heroes?

Join me. Find the truth.

The National Cipher Challenge is back! Visit [www.cipherchallenge.org](http://www.cipherchallenge.org) to enter. Ask Mr Glendinning for more details.

There are cash prizes for the best teams and for the best individuals so you can enter a team or as an individual. Last year the winners received £1000.

Skills in mathematics, computing, puzzles and languages are all useful.

Come to **C27** afterschool on the following dates for help cracking:

- **November: 7th, 14th, 21st and 28th**
- **December: 5th and 12th**

## CHESS CLUB

Chess club resumed this half term, 23 ranking matches were completed, including with six new members. Joseph Day and Michael Clark have increased their ratings the most, by 21 and 17 points respectively over this half term. Elliot Casselton and Michael Clark have been the most active members, managing to compete seven games each this half term.

Chess club will continue each Thursday lunchtime in C21 and new members are always welcome."



Hampshire  
County Council





# Yateley School Parents' Bulletin

## CAREERS and FUTURES fair



### YATELEY SCHOOL CAREERS & FUTURES FAIR 2019 THURSDAY 14th NOVEMBER

We all know that it is hard for students to make sense of the range of options available to them when thinking about their future careers. In order to help them with this we would like to invite them and you to the **Yateley Careers & Futures Fair** to be held in the Main Hall on **Thursday 14<sup>th</sup> November from 6.00pm to 8.00pm**. All students (from all year groups) are welcome.

We have a wide range of employers from the world of business/industry and training providers attending including colleges, universities and apprenticeships. There will also be representatives from the following: banking, architects, parliament, hotels, physiotherapy, care homes, retail, charity, performing arts, childcare, science and engineering, technology, healthcare, gaming, the Army and more. **It is a great opportunity to network and for Y10 and Y12 to make potential work experience contacts.** So please come along, bring your sons and daughters and let's help get them thinking about their exciting future!

*Mr M Tidd Careers Leader*



Hampshire  
County Council



# Yateley School Parents' Bulletin



***Save the date!***



**Saturday 2nd November  
Yateley Lions & Westfields  
Junior School's  
Fireworks Fiesta**

Westfields Junior School Playing Fields, School Lane.

**Gates Open 6.00pm**

**Bonfire 6.45pm**

**Fireworks 7.00pm**

Hotdogs, chips, refreshments & glow products  
available.

**Tickets available from:** Westfields Junior School,  
Simon's Video & Bottle shop, Yateley Angling Centre,  
DMK News (near Waitrose)

Adults £5.00  
(Advance £4)

Child (4-16yrs) £2.00  
Advance £1.50)



**NO PRIVATE FIREWORKS OR SPARKLERS!**



**Hampshire**  
County Council



# Yateley School Parents' Bulletin

## REMEMBRANCE SERVICE AND BIG BAND CONCERT

During the first week back after half term, we will be running Remembrance Assemblies. Poppies will be on sale during Tutor time and in Reception all week.

Any students who would like to join the Commemoration Service on Remembrance Sunday are asked to meet, wearing full school uniform, in St Swithuns Church Car Park at 3pm on Sunday 10th November. There will be a Parade to the Yateley War Memorial where wreaths will be laid and a short service of commemoration will take place. Students will be dismissed from there at around 4.15pm. Parents are welcome to join the back of the Parade.

There is also a Big Band Concert taking place in our Main Hall on Friday 8th November, organised by the Royal British Legion. Details below for anyone who would like to attend:

### BIG BAND CONCERT

**Yateley School Main Hall on**

**Friday 8<sup>th</sup> November 2019.**

**Music provided by the 30 -strong**

**Army Medical Services Band**

**Programme starts 7.30pm**

Cost - Adults £10.00 Children (u/18) £5.00

***Tickets available from Discoveries in Yateley, RBL desk in Waitrose or by calling 07770 628082***

